

Uniclass L325:P4142		EPIC F631:X442	
Cl/Sfb	(31.9)	Hh2	
April 2021			

catnic[®]

Lintels

Trade price list

Effective 1st April 2021



Lintels

Catnic is committed to offering brand leading steel lintels to suit any size, shape, length, breadth and depth of doorway, archway, window and aperture.



We are fully committed to providing first class service and support to the building industry. Our sales and technical teams are trained and experienced, with comprehensive product and industry knowledge.

Customer Services

To order or enquire about any Catnic product, please call on **029 2033 7900** or fax **029 2086 7796**.

Technical Services

For advice on the most appropriate lintel for wall constructions, loadings, products not listed in this price list or for further technical details, please call on **029 2033 7900**.

Lintel availability (all lintels)

Standard stocked products are available in 3-5 working days. Non-stocked products are available in 6 working days unless stated otherwise.

Next day delivery available. Terms and conditions apply.



Cavity Wall Lintels

100-115mm Inner Leaf

50-65mm Cavity Wall



(mm)	CG50/100	CH50/100	CX50/100
750	—	—	—
900	111.75	127.23	187.80
1050	—	146.55	220.16
1200	144.81	164.88	249.47
1350	—	188.49	282.62
1500	187.14	224.92	309.41
1650	—	272.85	342.36
1800	232.63	304.51	359.87
1950	—	350.04	403.71
2100	267.12	399.12	432.90
2250	—	420.16	487.92
2400	327.41	495.52	514.30
2550	—	—	534.58
2700	371.62	—	602.73
2850	—	—	660.19
3000	514.48	—	696.78
3300	574.31	—	802.62
3600	630.19	—	873.97
3900	—	—	1006.15
4200	—	—	1116.90
4575	—	—	1252.47
4800	—	—	1312.66

70-85mm Cavity Wall

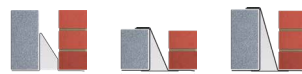

(mm)	CG70/100	CH70/100	CX70/100
750	—	—	—
900	108.38	127.24	188.54
1050	—	149.09	231.63
1200	144.62	169.25	261.97
1350	—	192.27	285.96
1500	180.64	242.74	313.13
1650	203.37	294.66	346.70
1800	226.12	319.62	364.30
1950	—	357.14	411.72
2100	258.61	400.81	425.00
2250	—	432.05	496.97
2400	306.56	498.81	573.89
2550	—	—	611.25
2700	353.81	—	654.60
2850	—	—	689.28
3000	503.47	—	727.84
3300	558.70	—	848.56
3600	609.36	—	927.42
3900	—	—	1031.23
4200	—	—	1152.76
4575	—	—	1258.30
4800	—	—	1335.09

90-105mm Cavity Wall

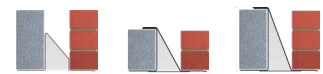

(mm)	CG90/100	CH90/100	CX90/100
750	96.23	—	—
900	112.72	153.99	204.56
1050	128.87	180.60	236.76
1200	150.26	206.43	268.52
1350	169.12	232.12	300.48
1500	187.87	266.54	332.45
1650	207.03	300.79	359.72
1800	226.12	327.40	395.51
1950	254.40	362.69	445.38
2100	268.94	405.98	477.20
2250	305.47	473.02	513.01
2400	324.28	507.02	573.14
2550	356.26	—	664.81
2700	388.30	—	704.48
2850	465.44	—	742.28
3000	505.15	—	795.52
3300	572.58	—	911.69
3600	628.35	—	994.65
3900	—	—	1109.27
4200	—	—	1271.93
4575	—	—	1427.11
4800	—	—	1522.26

Please note: All prices shown in GBP. Prices shown in Orange are non-stocked products and are available in 6 working days.

Cavity Wall Lintels

100-115mm Inner Leaf

110-125mm Cavity Wall

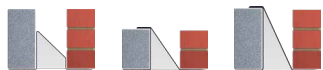

(mm)	CG110/100	CH110/100	CX110/100
750	110.82	—	—
900	132.93	208.29	246.69
1050	155.09	242.99	287.79
1200	177.27	277.70	328.89
1350	199.40	312.41	369.61
1500	221.54	347.12	411.12
1650	304.61	381.79	452.22
1800	332.34	416.53	493.31
1950	379.10	539.26	534.43
2100	408.28	580.75	575.55
2250	617.52	622.20	616.65
2400	658.71	663.70	739.96
2550	699.87	—	786.21
2700	741.05	—	832.46
2850	782.19	—	878.71
3000	821.98	—	924.94
3300	905.71	—	1101.93
3600	988.05	—	1235.85
3900	—	—	1410.77
4200	—	—	1537.44
4575	—	—	1676.99
4800	—	—	1755.80

130-145mm Cavity Wall

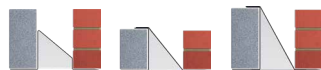

(mm)	CG130/100	CH130/100	CX130/100
750	144.62	—	—
900	173.54	213.35	253.81
1050	202.44	248.95	296.10
1200	231.36	284.46	338.39
1350	260.26	320.03	380.70
1500	289.21	355.57	423.00
1650	318.09	391.12	465.29
1800	346.99	426.67	507.59
1950	395.05	553.95	549.88
2100	425.44	596.53	592.16
2250	635.91	639.14	713.78
2400	678.31	681.75	761.33
2550	720.70	—	808.91
2700	763.08	—	856.54
2850	805.51	—	904.11
3000	847.88	—	951.68
3300	932.65	—	1258.58
3600	1017.44	—	1372.97
3900	—	—	1487.37
4200	—	—	1601.78
4575	—	—	1744.80
4800	—	—	1830.61

150-165mm Cavity Wall

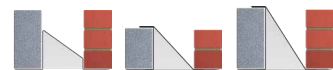

(mm)	CG150/100	CH150/100	CX150/100
750	150.75	—	—
900	180.88	221.84	259.50
1050	211.03	258.79	302.77
1200	241.15	295.75	346.01
1350	271.30	332.72	389.27
1500	301.43	369.71	432.49
1650	331.58	406.64	475.75
1800	361.74	443.62	518.99
1950	404.59	572.27	562.25
2100	435.73	616.29	605.47
2250	650.63	660.30	729.79
2400	693.98	704.32	778.45
2550	737.35	—	827.11
2700	780.75	—	875.75
2850	824.11	—	924.40
3000	867.47	—	973.05
3300	954.21	—	1287.97
3600	1040.96	—	1405.04
3900	—	—	1522.12
4200	—	—	1639.23
4575	—	—	1785.56
4800	—	—	1873.39

125-140mm Wide Inner Leaf

50-65mm Cavity Wall



(mm)	CG50/125	CH50/125	CX50/125
750	—	—	—
900	—	146.18	203.13
1050	—	187.87	236.99
1200	144.62	205.25	272.76
1350	—	235.67	304.67
1500	185.83	272.28	338.52
1650	—	306.34	362.80
1800	230.79	337.94	390.77
1950	—	400.50	423.11
2100	266.43	431.89	471.96
2250	—	466.70	536.95
2400	324.81	497.91	591.54
2550	—	—	659.15
2700	371.62	—	736.94
2850	—	—	812.13
3000	513.30	—	899.47
3300	—	—	989.58
3600	—	—	1079.50
3900	—	—	1168.62
4200	—	—	1298.16
4575	—	—	1391.52
4800	—	—	1483.85

70-85mm Cavity Wall



(mm)	CG70/125	CH70/125	CX70/125
750	—	—	—
900	—	189.96	207.80
1050	—	222.28	255.82
1200	181.33	260.61	279.19
1350	—	312.02	327.55
1500	228.21	346.97	353.68
1650	—	392.43	408.47
1800	313.18	428.41	437.83
1950	—	502.52	508.45
2100	368.78	539.56	556.92
2250	—	583.40	640.72
2400	509.13	645.03	694.09
2550	—	—	737.44
2700	597.79	—	780.80
2850	—	—	863.97
3000	832.34	—	931.30
3300	—	—	1025.69
3600	—	—	1151.99
3900	—	—	1235.75
4200	—	—	1355.28
4575	—	—	1460.06
4800	—	—	1542.98

90-105mm Cavity Wall



(mm)	CG90/125	CH90/125	CX90/125
750	128.49	—	—
900	154.21	222.28	229.13
1050	180.07	262.65	284.92
1200	202.49	289.59	316.08
1350	—	335.67	359.93
1500	252.49	367.25	438.71
1650	—	517.19	517.63
1800	319.45	557.79	564.72
1950	—	603.81	611.78
2100	378.58	656.63	670.96
2250	—	705.87	718.94
2400	534.77	752.94	766.84
2550	—	—	814.76
2700	618.80	—	874.56
2850	—	—	913.36
3000	889.97	—	993.75
3300	—	—	1107.70
3600	—	—	1233.74
3900	—	—	1316.19
4200	—	—	1410.86
4575	—	—	1531.24
4800	—	—	1605.00

Please note: All prices shown in GBP. Prices shown in Orange are non-stocked products and are available in 6 working days.

125-140mm Wide Inner Leaf

110-125mm Cavity Wall

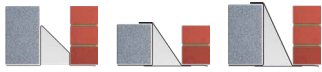

(mm)	CG110/125	CH110/125	CX110/125
750	130.70	—	—
900	156.85	222.60	256.65
1050	182.97	259.69	299.43
1200	209.12	296.80	342.18
1350	235.26	333.88	384.96
1500	261.39	370.98	499.00
1650	297.13	529.28	548.90
1800	329.42	577.41	598.78
1950	383.48	625.50	648.70
2100	456.82	673.63	698.57
2250	595.28	721.76	748.47
2400	670.14	769.86	926.67
2550	712.05	—	984.58
2700	753.91	—	1042.51
2850	795.80	—	1100.44
3000	837.69	—	1158.35
3300	—	—	1313.51
3600	—	—	1432.93
3900	—	—	1552.33
4200	—	—	1671.73
4575	—	—	1821.00
4800	—	—	1910.56

130-145mm Cavity Wall

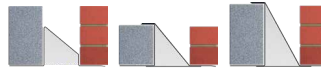

(mm)	CG130/125	CH130/125	CX130/125
750	191.66	—	—
900	196.03	262.58	356.64
1050	227.54	306.33	416.11
1200	259.07	350.09	475.54
1350	289.31	393.83	534.97
1500	319.57	437.61	594.39
1650	355.30	481.37	653.79
1800	391.02	525.14	713.26
1950	431.69	665.50	772.69
2100	511.32	716.73	832.13
2250	649.78	767.91	891.54
2400	693.19	819.09	950.99
2550	791.47	—	1010.41
2700	838.03	—	1069.88
2850	884.57	—	1129.32
3000	931.06	—	1188.75
3300	—	—	1352.67
3600	—	—	1475.67
3900	—	—	1598.64
4200	—	—	1721.60
4575	—	—	1875.36
4800	—	—	1967.55

150-165mm Cavity Wall

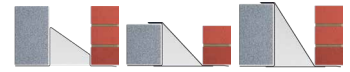

(mm)	CG150/125	CH150/125	CX150/125
750	210.85	—	—
900	220.39	278.34	408.48
1050	257.11	324.71	476.58
1200	293.82	371.03	544.61
1350	330.54	417.43	612.68
1500	367.25	463.80	680.05
1650	403.98	510.25	748.83
1800	440.70	556.64	816.93
1950	485.19	642.36	884.96
2100	565.82	691.75	953.04
2250	704.29	741.16	1021.03
2400	742.87	790.57	1089.19
2550	758.38	—	1157.28
2700	885.71	—	1225.28
2850	925.78	—	1289.41
3000	965.81	—	1357.94
3300	—	—	1549.24
3600	—	—	1690.11
3900	—	—	1830.93
4200	—	—	1971.76
4575	—	—	2147.85
4800	—	—	2253.48

140-150mm Wide Outer Leaf

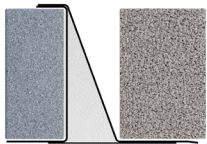

A full range of lintels is available to suit wide outer leaf applications please contact Catnic Technical Department for further information and prices.

Thermally Broken Cavity Wall Lintels

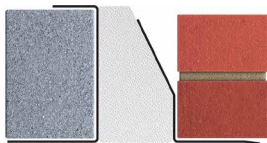

A full range of Thermally Broken Cavity lintels prices is available on demand, please contact Catnic Technical Department for further information and prices.

Closed Eaves

Cavity Wall 90-125mm



(mm)	CGE90/100
750	65.11
900	78.68
1050	95.05
1200	104.37
1350	117.45
1500	132.45
1650	147.29
1800	181.10
1950	—
2100	212.26
2250	—
2400	302.34
2550	—
2700	339.93
2850	—
3000	—
3300	—
3600	—
3900	—
4200	—
4575	—
4800	—

Extreme Loads*

Cavity 50-65mm 70-85mm

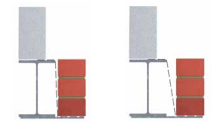

CXL240	CXL265
638.35	691.97

Cavity 90-105mm 110-125mm

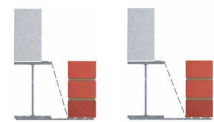

CXL290	CXL310
799.20	903.95

Cavity 130-145mm 150-165mm

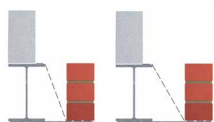

CXL330	CXL350
932.33	960.76

*Price per metre Product available in 8-10 working days

Internal Solid Walls

75mm and 100 mm

Cavity	75mm	100mm	100mm	100mm	100mm	100mm	140mm	140mm	140mm
(mm)	CN92	CN102	CN100	BSD100	BHD100	BXD100	BSD140	BHD140	BXD140
750	—	—	—	89.96	104.17	160.03	—	—	—
900	—	—	—	98.72	114.31	192.05	—	—	—
1050	19.55	24.73	60.36	108.24	125.33	224.04	117.06	131.70	235.73
1200	22.12	27.29	74.98	111.04	128.57	260.96	133.80	150.52	269.40
1350	—	—	—	117.82	136.41	285.45	150.52	169.32	303.09
1500	—	—	—	124.75	147.48	311.67	167.23	188.13	336.75
1650	—	—	—	157.98	318.09	415.87	183.96	358.94	435.58
1800	—	—	—	172.82	341.15	453.68	200.67	391.57	475.18
1950	—	—	—	188.06	354.45	491.48	217.40	424.21	514.77
2100	—	—	—	197.52	381.71	529.28	234.11	456.82	554.36
2250	—	—	—	233.85	385.66	537.71	259.10	489.47	593.97
2400	—	—	—	249.52	411.31	580.94	276.57	522.07	633.56
2550	—	—	—	270.24	436.99	583.04	293.91	554.72	673.16
2700	—	—	—	285.83	462.72	590.51	311.59	587.34	712.74
2850	—	—	—	471.21	595.13	—	619.97	681.75	—
3000	—	—	—	496.15	616.65	—	652.60	717.62	—
3300	—	—	—	547.78	689.08	—	717.86	789.38	—
3600	—	—	—	599.21	751.74	—	783.11	861.14	—
3900	—	—	—	803.50	1405.55	—	932.90	1577.22	—
4200	—	—	—	865.31	1513.67	—	1004.67	1698.52	—
4575	—	—	—	942.56	1646.01	—	1094.36	1850.24	—
4800	—	—	—	970.33	1729.88	—	1148.18	1941.23	—

External Solid Walls

Exterior Solid Wall 200 and 215mm

(mm)	CN71A	CN71C	CN81B	CN81C	CN50C	CN51C
750	—	—	—	—	—	—
900	142.17	237.13	—	—	142.17	—
1050	165.58	276.65	—	—	—	—
1200	183.59	316.15	—	—	183.59	—
1350	212.40	355.64	—	—	212.40	—
1500	240.45	395.20	—	—	240.45	—
1650	265.33	434.67	—	—	—	—
1800	290.25	474.20	—	—	290.25	—
1950	298.98	513.72	—	—	—	—
2100	338.21	—	566.67	704.40	—	338.21
2250	396.06	—	575.59	754.65	—	—
2400	421.20	—	613.86	773.05	—	421.20
2550	435.36	—	652.27	799.74	—	—
2700	460.82	—	678.00	820.97	—	460.82
2850	—	—	691.53	887.44	—	—
3000	—	—	709.53	932.97	—	—
3300	—	—	741.31	965.51	—	—
3600	—	—	837.04	1048.39	—	—
3900	—	—	—	1131.59	—	—
4200	—	—	—	1200.77	—	—
4575	—	—	—	1258.69	—	—
4800	—	—	—	1341.59	—	—

Fairface Brick 215mm

Single Leaf

102mm Exterior Wall

(mm)	MBA	ANG	CCS
750	40.48	—	64.59
900	—	64.78	76.96
1050	—	75.56	90.33
1200	—	86.20	102.87
1350	72.71	97.00	116.11
1500	—	107.85	128.84
1650	—	133.44	141.59
1800	—	145.50	154.56
1950	—	157.47	212.03
2100	—	171.60	228.30
2250	—	222.76	244.63
2400	—	237.25	260.94
2550	—	344.53	369.63
2700	—	364.87	391.38
2850	—	401.34	413.12
3000	—	441.49	434.84
3300	—	615.55	765.19
3600	—	671.54	834.78
3900	—	727.48	904.33
4200	—	—	973.89
4575	—	—	1060.82
4800	—	—	1113.02

Please note: All prices shown in GBP. Prices shown in Orange are non-stocked products and are available in 6 working days.

Timber Frame Lintel

Cavity 50-65mm 70-85mm 90-105mm



(mm)	CTF5	CTF7	CTF9
750	39.82	41.75	49.39
900	47.52	50.09	58.32
1050	55.75	58.39	68.45
1200	63.68	66.70	78.35
1350	74.90	94.62	88.82
1500	82.01	105.14	101.88
1650	101.52	125.40	124.10
1800	110.85	136.81	139.01
1950	124.86	148.21	157.26
2100	136.89	159.60	169.39
2250	167.35	171.02	192.65
2400	183.59	182.41	224.39
2550	199.45	280.19	258.08
2700	213.17	296.75	273.61
2850	281.16	313.18	344.11
3000	296.03	329.66	362.25
3300	329.23	390.73	519.97
3600	492.40	426.23	567.27
3900	533.57	505.37	699.94
4200	574.67	544.30	753.77
4575	615.58	592.84	821.07
4800	647.12	622.02	861.47

Heavy duty CTFs are available on request. All timber frame lintels must be fixed using restraint clips which are supplied free of charge.

Arch Lintels

Standard Semi-circular Arch Lintels



CCA600	CCA630	CCA900	CCA915	CCA1200
420.9	436.18	574.34	582.26	730.31

CCB600	CCB630	CCB900	CCB915	CCB1200
447.95	464.28	611.47	619.95	777.84

Product available in 5 working days.

Arch Centres



Code	Length (mm)	Structural Opening (mm)	Rise (mm)	£/each
ACA0475	475	450-500	75	69.88
ACA0625	625	600-650	75	78.54
ACA0675	675	650-700	75	85.37
ACA0875	875	850-900	75	91.86
ACA0925	925	900-950	75	94.86
ACA1075	1075	1050-1100	75	102.14
ACA1225	1225	1200-1250	75	109.71
ACA1375	1375	1350-1400	75	118.87
ACA1475	1475	1450-1500	75	128.63
ACA1625	1625	1600-1650	75	138.87
ACA1775	1775	1750-1800	75	149.75
ACA2125	2125	2100-2150	75	231.29
ACA2325	2325	2300-2350	75	254.94
ACA2425	2425	2400-2450	75	254.94

Special Lintels

A range of exciting shapes for unique designs and feature brickwork to inspire today's architects and builders.

Prices available on application. All made to order lintels are available in 10 working days from receipt of order and approved drawing.

Examples



Parabolic Arch Lintel



Bull's Eye Lintel



Curved On Plan Lintel

Stainless Steel Lintels

All galvanised steel lintel products shown in the current lintel brochure are available in stainless steel. Special lintels are also available in stainless steel. **Prices available on application.**

Juliet Balconies

A standard range of Juliet Balconies are available from Catnic. Juliet Balconies are commonly used to provide a safety barrier in front of French windows. **Prices available on application.**

Accessories

Weep Vents (50 per box)

Terracotta	Grey	Beige
40.01	40.01	40.01



PVCu Soffit Cladding (Price per metre)

FC White
9.96

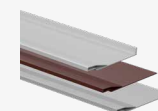

Stop Ends (50 per box)

C90	CL3
79.34	79.34



External Plaster Key

PKS87
114.58 per pack - 10 x 1.2m



www.catnic.com

Catnic Conditions of Sale can be downloaded from www.catnic.com/downloads

This price list supersedes all previous lists. All prices are for normal UK delivery, £ Sterling and exclusive of VAT. Catnic reserves the right to revise prices and product specifications described herein without prior notice.

Care has been taken to ensure that the contents of this publication are accurate, but Tata Steel Europe Limited and its subsidiaries do not accept responsibility or liability for errors or information that is found to be misleading.

© Copyright 2021 Tata Steel UK Limited.

Catnic
Pontypandy Industrial Estate
Caerphilly
CF83 3GL

T: 029 2033 7900
F: 029 2086 7796

English version



01/04/21